

# Shower arm f/ ceiling 100 mm

## Qtoo collection

**Product** 100mm, Ø90mm, satin finish.

**Tender text** QTOO collection, shower arm for ceiling, length 3 15/16"-100mm. Manufactured in the highest quality marine grade, AISI 316 stainless steel, protecting against high levels of corrosion. 20 year warranty.

**Product specification** Arm projection: 100mm - 3 15/16"  
1/2" connection  
Rose diameter: Ø90mm - 3 1/2"  
Material: Marine grade AISI 316 stainless steel  
Lead free compliant  
[20-year warranty \(5 years for coated items\)](#)

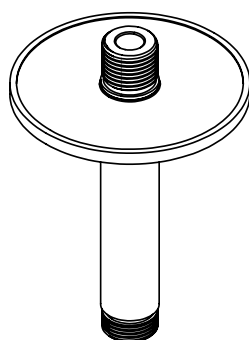
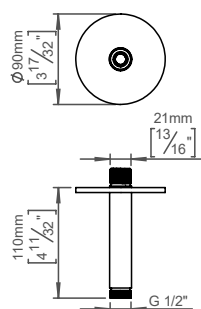

### Available finishes

#### Solid metal



Satin steel

Polished steel

#### PVD



Black

Copper

Brass

Bronze

#### Powder coated



Black

### Spare parts/ accessories

### Mounting

<https://dline.com/mounting-instructions/>

### Product care

d line products are produced in the highest quality marine grade AISI 316 stainless steel. To sustain the unique d line finish please follow the below instructions:

- Wash down the surfaces using soapy water or mild detergent
- Always thoroughly rinse off with clean water
- To complete the cleaning procedure dry/polish the surface with a soft dry cloth

Please do not use scouring powder, steel wool, chloride based detergents or other aggressive cleaning products as these may damage the surface.

If spots or corrosion appear on the surface it is not due to the stainless steel quality, but to impurities in the environment, aggressive conditions or improper or insufficient cleaning.